



# Merchandisers

## SWING DOOR

- ARM-10A
- AFM - 17
- ARM-17A

## STANDARD FEATURES

### ⌘ DURABLE CONSTRUCTION

Our merchandisers boast a sturdy stainless steel floor and easy to clean, NSF approved white coated steel. Exterior is no-chip white paint. Also available in black as special order from factory.

### ⌘ ERGONOMICALLY DESIGNED DOORS

"Low E" double pane thermal insulated glass doors on refrigerators and triple pane on freezers. All come with easy grip handles on the aluminium frame and self closing/90 ° stay open door feature, working together for customer convenience.

### ⌘ MAGNETIC DOOR GASKET

Built of one piece, the magnetic gasket is removable without tools with positive seal closure assuring ease of cleaning and replacement.

### ⌘ ANALOG CONTROLLER

This temperature control system on refrigerators and freezers allows customers to keep the utmost food quality for a longer period of time.

### ⌘ HIGH DENSITY POLYURETHANE INSULATION

Ecomate® CFC-free polyurethane insulation foamed in place including the mullion on double doors for extra strength and energy efficiency, while being environmentally friendly with zero ozone depletion potential (ODP) and zero global warming potential (GWP).

### ⌘ EFFICIENT REFRIGERATION SYSTEM

Factory engineered oversized and balanced refrigeration system. CFC-free R-134A Refrigerators maintain temperature from 33° to 38°F and R-404A Freezers maintain temperature at -10°F.

### ⌘ BOTTOM MOUNT COMPRESSOR

Allows easier access with service friendly rails while adding more storage space above. This system provides a cool and clean operating environment enhancing the compressor life.

### ⌘ SHELVES

Adjustable epoxy coated wire shelves.

### ⌘ LED LIGHT

"Low-E" consumption LED interior lights lasts up to 10 times longer compared to fluorescent light, providing greater visibility, shadow-free illumination and enhanced product display.



ARM-10A



ARM-17A



AFM-17

## OPTIONS & ACCESSORIES

Additional epoxy coated shelves / 2.5" Casters / 4" Casters / 6" Adjustable stainless steel legs / Factory reverse door hinging / 220V-50 cycles- 1 phase



ISO 9001

MODEL	DOORS	CAPACITY (Cu.Ft)	SHELVES	AMPS	HP	VOLTAGE	NEMA PLUG	Cord Lenght	Cabinet Dimensions L" D" * H"	Shipping Wt. lbs.	Cubes
REFRIGERATORS											
ARM-10A	2	9.8	8	5.1	1/4	115/60/1	5-15P	8'	36 21 3/4 54	203	30
ARM-17A	1	16	4	5.8	3/4	115/60/1	5-15P	8'	27 26 1/4 72 5/8	268	37
FREEZERS											
AFM-17	1	16	4	7.9	1	115/60/1	5-15P	8'	27 26 3/8 72 5/8	283	37

\*Depth does not include 1 5/8" per door handle.

ARM-10A FRONT

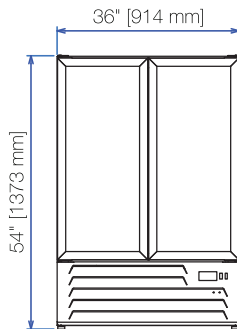

ARM-10A SIDE

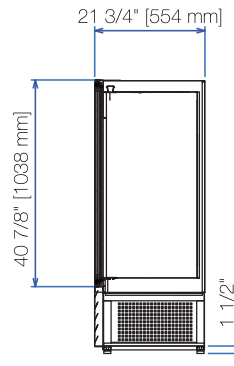

ARM-10A TOP

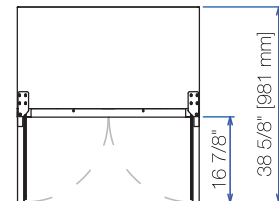

ARM-17(A) FRONT

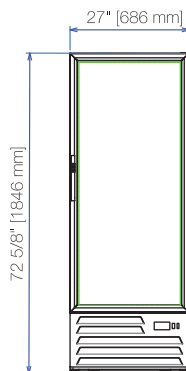

ARM-17(A) SIDE

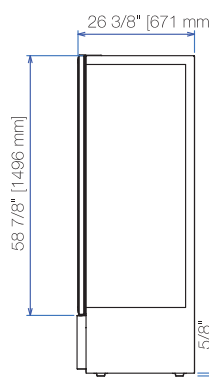

ARM-17(A) TOP

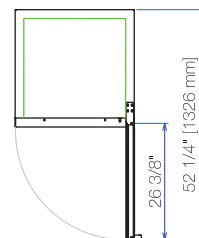

## \* Specifications



ISO 9001

### ④ CONSTRUCTION

- Our merchandisers boast a sturdy stainless steel floor and easy to clean, NSF approved white coated steel. Exterior is no-chip white vinyl. Also available in black as special order from factory.
- "Low-E" consumption LED interior lights lasts up to 10 times longer compared to fluorescent light, providing greater visibility, shadow-free illumination and enhanced product display.

### ④ DOORS & SHELVES

- "Low E" double pane thermal insulate glass doors on refrigerators and triple pane on freezers. All come with easy grip handles and self closing-90 ° stay open door feature, working together for customer convenience.
- Adjustable epoxy coated wire shelves.

### ④ REFRIGERATION SYSTEM

- Factory engineered oversized and balanced refrigeration system. CFC-free R-134A Refrigerators maintain temperature from 33° to 38°F and R-404A Freezers maintain temperature at -10°F.
- Allows easier access with service friendly rails while adding more storage space above. This system provides a cool and clean operating environment enhancing the compressor life.
- Large fan motor and fan blades for better air circulation.

- Analog temperature control system on refrigerators and digital on freezers allows customers to keep the utmost food quality for a longer period of time.
- Ecomate® CFC-free polyurethane insulation foamed in place including the mullion on double doors for extra strength and energy efficiency, while being environmentally friendly with zero ozone depletion potential (ODP) and zero global warming potential (GWP).

### ④ ELECTRICAL

- The whole unit is completely pre-wired at factory with cord and plug set included and ready for final connection to a 115/60/1 phase.
- 220V/50Hz/1ph available from factory.

### ④ WARRANTY

Continental USA & Canada:

- One year:** Labor and parts warranty.
- Five year:** Compressor warranty.
- International:** One year parts only.

\* Asber's specification are subject to change without notice as we continue to make product improvements.