

Blueair by
BLUENIX

THREE COMPARTMENT SINKS

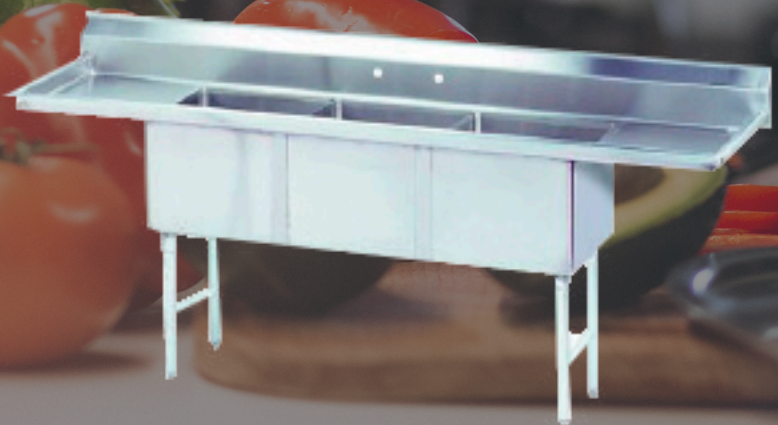

BS3-18-12/2D



BS3-18-12/L



BS3-18-12/N



BS3-18-12/R

STANDARD FEATURES



Entire ASSEMBLY is fused Welded
shielded and polished to create a one piece
seamless sink Unit



Adjustable ABS bullet feet
Enhanced Functionality.



Stainless Steel cross braced legs and gussets
additional strength and stability

- Swirl away bowl drainage
- All sink compartments are covered With a full 5/8" radius
- Welded areas are high-speed belt blended to match adjacent surfaces with the continuity of a satin finish
- All Sink Models Equipped with standard strainers with Brass Fittings instead of Aluminum
- Die-stamped creased drain boards for positive drainage

Blueair by
BLUENIX

BLUE AIR has right to change specifications without further notice.

Top view

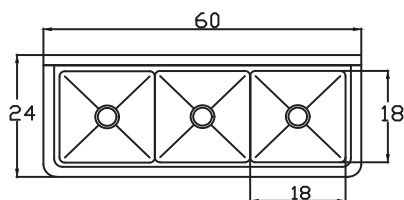

Front view

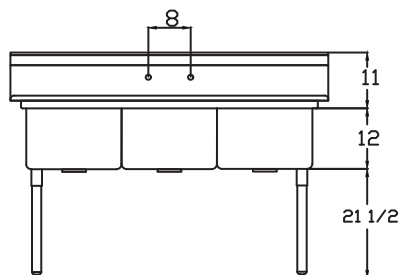

BS3-18-12/N

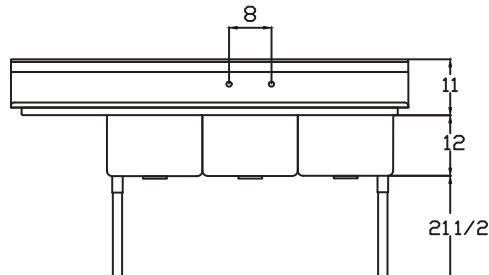
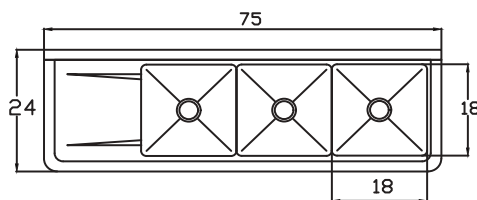

BS3-18-12/L

Side view

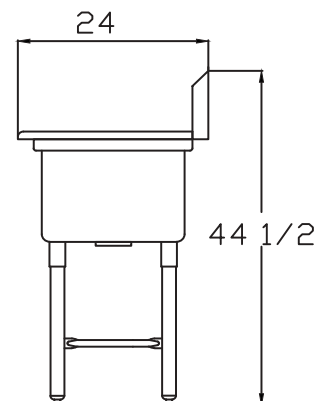

Top view

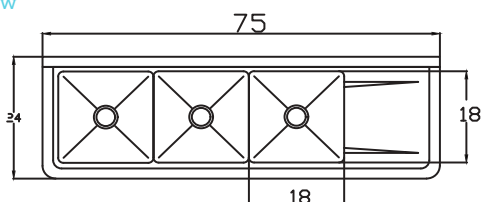

Front view

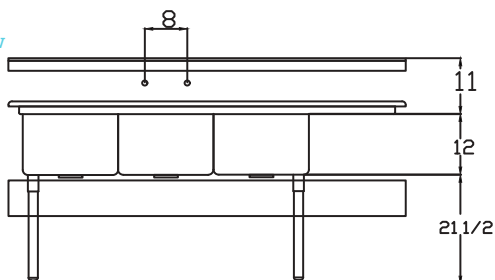

BS3-18-12/R

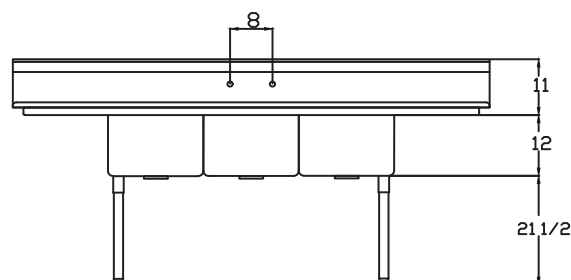
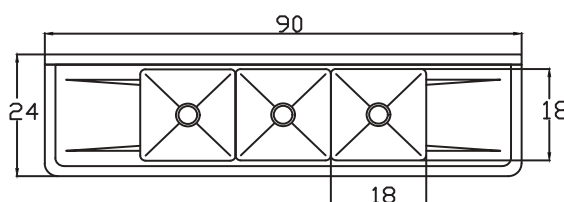

BS3-18-12/2D

Model	Overall size (inches/mm)			Bowl Size (inches/mm)		
	L	D	H	L	D	H
BS3-18-12/N	60"(1524mm)	24"(610mm)	44 1/2"(1130mm)	18"(458mm)	18"(458mm)	12"(305mm)
BS3-18-12/L	75"(1905mm)	24"(610mm)	44 1/2"(1130mm)	18"(458mm)	18"(458mm)	12"(305mm)
BS3-18-12/R	75"(1905mm)	24"(610mm)	44 1/2"(1130mm)	18"(458mm)	18"(458mm)	12"(305mm)
BS3-18-12/2D	90"(2286mm)	24"(610mm)	44 1/2"(1130mm)	18"(458mm)	18"(458mm)	12"(305mm)

Weight (lbs/kg)		
Net Weight		Ship Weight
BS3-18-12/N	72(33)	79(36)
BS3-18-12/L	81(37)	89(40)
BS3-18-12/R	81(37)	89(40)
BS3-18-12/2D	85(39)	93(42)



blueairfse.com



orders@blueairfse.com



1.886.677.8500



223 W. Rosecrans Ave., CA 90248
T: 310.808.0102

9 W. Shelton Terrace #A, Hillside, NJ 07205
T: 908-688-0970